

## 3M Light Cinema Dome

The Omnispace 3MLCD was developed to streamline content production and exhibition in immersive formats.

Whether integrating it into a theater's content production workflow or displaying content in limited spaces such as exhibition and entertainment areas - this system has the capabilities of an entire theater with the footprint of a standard workspace.

In addition to the standard height and tilt adjustable legs, this lightweight aluminum system also allows for creative mounting options such as hanging for digital signage, immersive environments, and high impact data visualization.

Includes a complete system: Cinema dome, Omnispace server, iPad with user interface, projection system, and 5.1 surround sound.

Numerous upgrades, accessories, software modules, and content options are available.

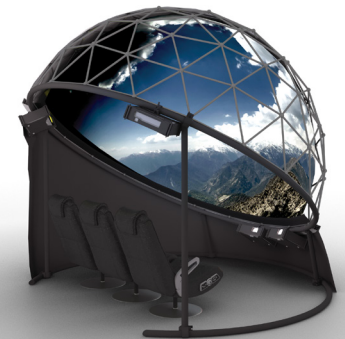
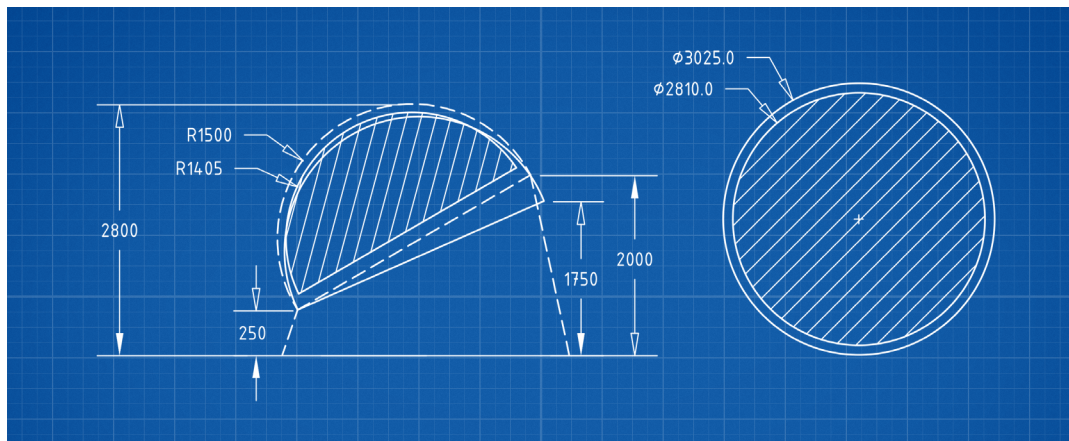

Standard AV (upgradable)		Space		Dimensions		Environment		Installation	
# Projectors	4	Floor Area	6.6 m <sup>2</sup>	Diameter	3 m	Indoor/Outdoor	Indoor only	Shipping Weight	130 kg
Active Resolution (Arc)	3K	Screen Area	12.3 m <sup>2</sup>	Height	2.45 to 3.2 m	Frame	1/2" Al6061 T6	Dome Setup Time	2.5-5 hours
Active Pixels	6635500	Standing Capacity	6	Width	3 m	Truss	2" tilt adjustable	Dismantle Time	2-3 hours
Visible Lumens	6000	Standard Chair Capacity	6	Door Width	2 m	Wind Load	N/A	Total Ballast Weight	N/A
Contrast	10,000:1	Theater Seat Capacity	4	Door Height	2 m	Snow Load	N/A	# Ballast Points	N/A
Display Technology	DLP	Luxury Seat Capacity	3			Fire Rating	Synthetic self-extinguishing	Electrical (standard)	1.5 kW avg, 2.3 kW max
Audio	5.1 Surround	Number of Doors	Open design						

## 5M Light Cinema Dome

The Omnispace 5MLCD was developed to create a simple solution for displaying immersive 360° content with uncompromising visual fidelity. Whether enabling engaging educational applications or playing media at events and entertainment venues - this system has the capabilities and performance of a full theater, all in one powerful package.

The 5MLCD is ideal for use cases such as:

- Immersive VR theater
- Education and simulation
- Parties and events
- Digital signage
- Rides and gaming
- Content production

Includes a complete system: Cinema dome, Omnispace server, iPad with user interface, projection system, and 5.1 surround sound.

Numerous upgrades, accessories, software modules, and content options are available.

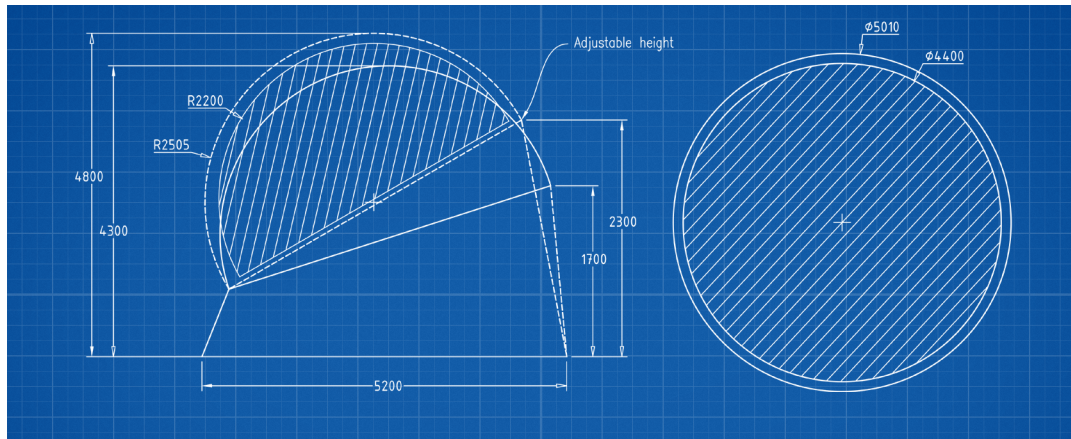

Standard AV (upgradable)		Space		Dimensions		Environment		Installation	
# Projectors	4	Floor Area	19 m <sup>2</sup>	Diameter	5 m	Indoor/Outdoor	Indoor only	Shipping Weight	200 kg
Active Resolution (Arc)	3K	Screen Area	34 m <sup>2</sup>	Height	4 to 4.8 m	Frame	1/2" Al6061 T6	Dome Setup Time	6-8 hours
Active Pixels	6635500	Standing Capacity	18	Width	5.2 m	Truss	2" tilt adjustable	Dismantle Time	3-4 hours
Visible Lumens	6000	Standard Chair Capacity	14	Door Width	2.5 m	Wind Load	N/A	Total Ballast Weight	N/A
Contrast	10,000:1	Theater Seat Capacity	8 to 12	Door Height	2.5 m	Snow Load	N/A	# Ballast Points	N/A
Display Technology	DLP	Luxury Seat Capacity	5 to 8			Fire Rating	Synthetic self-extinguishing	Electrical (standard)	1.5 kW avg, 2.3 kW max
Audio	5.1 Surround	Number of Doors	1						



## 5EC Light Cinema Dome

The Omnispace 5EC was developed to create a simple solution for displaying immersive 360° content with uncompromising visual fidelity. Whether enabling engaging educational applications or playing media at events and entertainment venues - this system has the capabilities and performance of a full theater, all in one powerful package.

The 5EC is ideal for use cases such as:

- Immersive VR theater
- Education and simulation
- Parties and events
- Digital signage
- Rides and gaming
- Content production

Includes a complete system: Cinema dome, Omnispace server, iPad with user interface, projection system, and 5.1 surround sound.

Numerous upgrades, accessories, software modules, and content options are available.

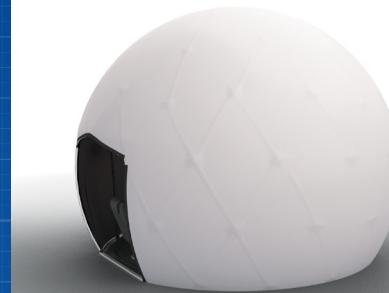
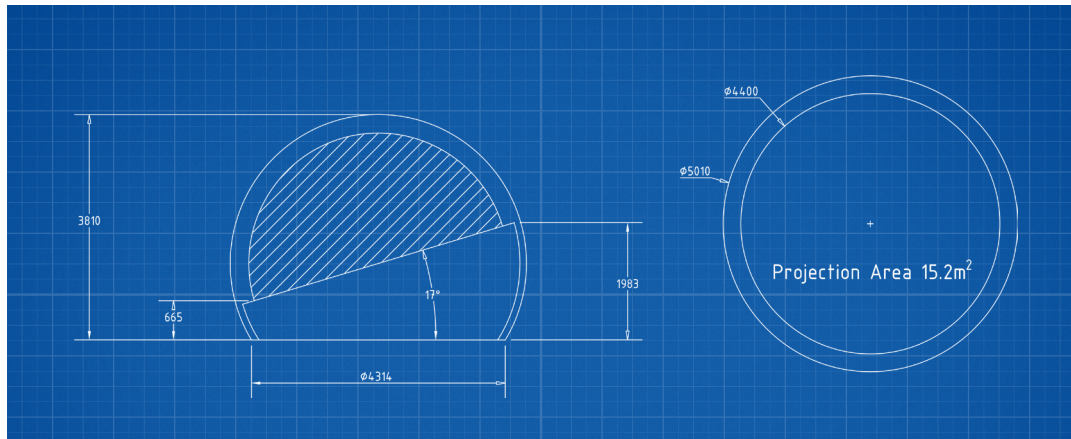

Standard AV (upgradable)		Space		Dimensions		Environment		Installation	
# Projectors	4	Floor Area	14.3 m²	Diameter	5 m	Indoor/Outdoor	Yes/Yes	Shipping Weight	270 kg
Active Resolution (Arc)	3K	Screen Area	30.4 m²	Height	3.8 m.	Frame	1" Al6061 T6	Dome Setup Time	6-8 hours
Active Pixels	6635500	Standing Capacity	18	Width	5 m.	Truss	Provided additionally	Dismantle Time	3-4 hours
Visible Lumens	6000	Standard Chair Capacity	14	Door Width	1.74 m.	Wind Load	Storm wind 35m/s	Total Ballast Weight	2716 kg
Contrast	10.000:1	Theater Seat Capacity	8 to 12	Door Height	2 m.	Snow Load	250 kg at m²	# Ballast Points	14
Display Technology	DLP	Luxury Seat Capacity	5 to 8			Fire Rating	PVC self-extinguishing	Electrical (standard)	1.5 kW avg, 2.3 kW max
Audio	5.1 Surround	Number of Doors	1						

## 7M Light Cinema Dome

The Omnispace 7MLCD was developed to create a simple solution for displaying immersive 360° content with uncompromising visual fidelity. Whether enabling engaging educational applications or playing media at events and entertainment venues - this system has the capabilities and quality of a full theater, all in one powerful package.

The 7MLCD is ideal for use cases such as:

- Immersive VR theater
- Education and simulation
- Events and entertainment
- Rides and gaming

Includes a complete system: Cinema dome, Omnispace server, iPad with user interface, projection system, and 5.1 surround sound.

Numerous upgrades, accessories, software modules, and content options are available.

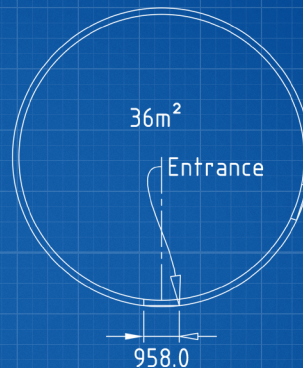
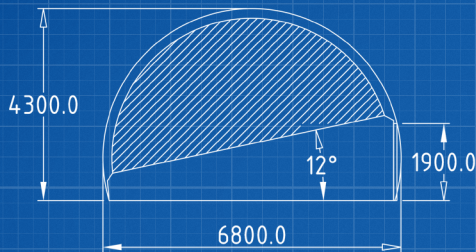

Standard AV (upgradable)		Space		Dimensions		Environment		Installation	
# Projectors	4	Floor Area	36 m <sup>2</sup>	Diameter	6.8 m	Indoor/Outdoor	Indoor / Restricted Outdoor	Shipping Weight	130 kg
Active Resolution (Arc)	3K	Screen Area	70 m <sup>2</sup>	Height	4.3 m	Frame	0.55" 2" Al6061 T6	Dome Setup Time	2-3 hours
Active Pixels	6635500	Standing Capacity	38	Width	6.8 m	Truss	2" Al6061 T6	Dismantle Time	1-2 hours
Visible Lumens	9000	Standard Chair Capacity	28	Door Width	0.9 m	Wind Load	Occasional 12 m/s	Total Ballast Weight	N/A
Contrast	16,000:1	Theater Seat Capacity	21	Door Height	1.9 m	Snow Load	N/A	# Ballast Points	N/A
Display Technology	DLP	Luxury Seat Capacity	12	Vent Openings	2X 30 cm	Fire Rating	Synthetic self-extinguishing	Electrical (standard)	1.9 kW avg, 2.8 kW max
Audio	5.1 Surround	Number of Doors	1						

## 8M Immersive Event Dome

Deliver immersive and unforgettable 360° experiences to audiences anywhere. Our Immersive Event Domes have overhead projection and can be used for standing or seated experiences in numerous configurations. Their reinforced structures are suitable for outdoor use.

The 8M Immersive Event Dome is ideal for:

- Creating digital and dynamic environments
- Events and exhibitions
- Education and simulation- Bringing 360 VR content to large audiences (approx 35X the throughput of a VR head mounted display)
- Music, art, and dance
- Live and interactive presentations and performances.

Includes a complete system: dome, Omnispace server, iPad with user interface, projection system, and 5.1 surround sound.

Numerous upgrades, accessories, software modules, and content options are available.

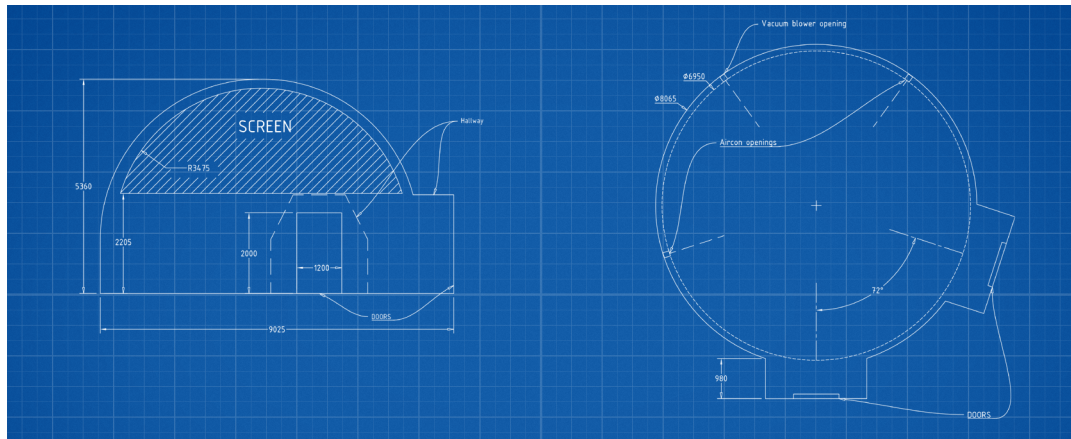

Standard AV (upgradable)		Space		Dimensions		Environment		Installation	
# Projectors	8	Floor Area	49.5 m <sup>2</sup>	Diameter	8 m	Indoor/Outdoor	Indoor and outdoor rated	Shipping Weight	1240 kg
Active Resolution (Arc)	4.5K	Screen Area	69.9 m <sup>2</sup>	Height	5.6 m	Frame	1", 2" Al6061 T6	Dome Setup Time	Site determined
Active Pixels	13271000	Standing Capacity	50	Width	8 m	Truss	2" Al6061 T6	Dismantle Time	Site determined
Visible Lumens	24280	Standard Chair Capacity	36	Door Width	1.2 m	Wind Load	78 MPH. Beaufort 11	Total Ballast Weight	Site determined
Contrast	10.000:1	Theater Seat Capacity	29	Door Height	2 m	Snow Load	250 kg per m <sup>2</sup>	# Ballast Points	Site determined
Display Technology	DLP	Luxury Seat Capacity	20	Door Distance	6.3 m	Fire Rating	Synthetic self-extinguishing	Electrical (standard)	3.2 kW avg, 4.3 kW max
Audio	5.1 Surround	Number of Doors	2	Vent Openings	2X 45cm. 2X 15cm				



## 10M Light Cinema Dome

The Omnispace 10MLCD was developed to create a simple solution for displaying immersive 360° content with uncompromising visual fidelity. Whether enabling engaging educational applications or playing media at events and entertainment venues - this system has the capabilities and quality of a full theater, all in one powerful package.

The 10MLCD is ideal for use cases such as:

- Immersive VR theater (approx 50X the throughput of a VR head mounted display)
- Education and simulation
- Events and entertainment
- Rides and gaming

Includes a complete system: Cinema dome, Omnispace server, iPad with user interface, projection system, and 5.1 surround sound.

Numerous upgrades, accessories, software modules, and content options are available.

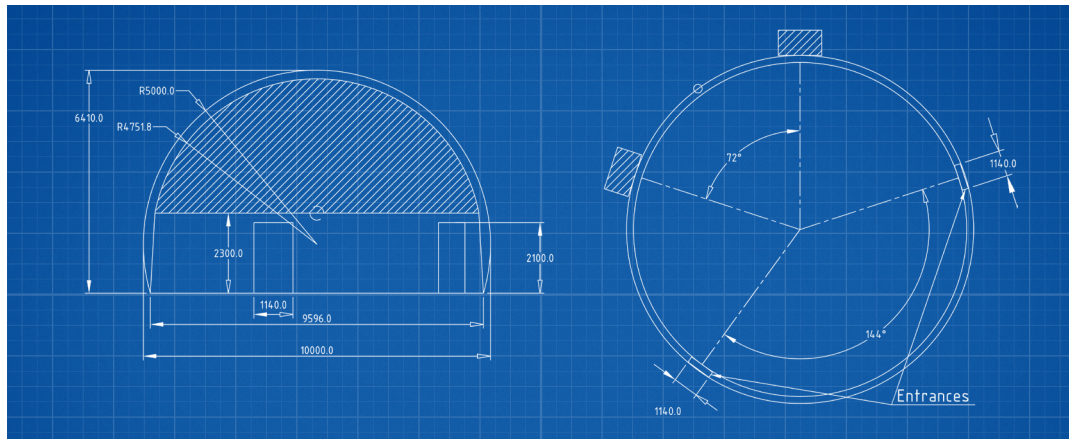

Standard AV (upgradable)		Space		Dimensions		Environment		Installation	
# Projectors	8	Floor Area	73 m <sup>2</sup>	Diameter	10 m	Indoor/Outdoor	Yes / Restricted outdoor	Shipping Weight	250 kg
Active Resolution (Arc)	4.5K	Screen Area	140 m <sup>2</sup>	Height	6.4 m	Frame	25mm, 50mm Al6061 T6	Dome Setup Time	4-8 hours
Active Pixels	13271000	Standing Capacity	74	Width	10 m	Truss	50mm Al6061 T6	Dismantle Time	3-5 hours
Visible Lumens	24280	Standard Chair Capacity	53	Door Width	1.2 m	Wind Load	Occasional 12 m/s gusts	Total Ballast Weight	500
Contrast	10.000:1	Theater Seat Capacity	49	Door Height	2 m	Snow Load	N/A	# Ballast Points	18
Display Technology	DLP	Luxury Seat Capacity	23	Vent Openings	2X 300 mm	Fire Rating	Synthetic self-extinguishing	Electrical (standard)	3.2 kW avg, 4.3 kW max
Audio	5.1 Surround	Number of Doors	2						

## 12M Light Cinema Dome

The Omnispace 12MLCD was developed to create a simple solution for displaying immersive 360° content with uncompromising visual fidelity. Whether enabling engaging educational applications or playing media at events and entertainment venues - this system has the capabilities and quality of a full theater, all in one powerful package.

The 12MLCD is ideal for use cases such as:- Immersive VR theater (approx 80X the throughput of a VR head mounted display)

- Education and simulation- Events and entertainment
- Rides and gaming
- Music, art, and dance

Includes a complete system: Cinema dome, Omnispace server, iPad with user interface, projection system, and 5.1 surround sound.

Numerous upgrades, accessories, software modules, and content options are available.

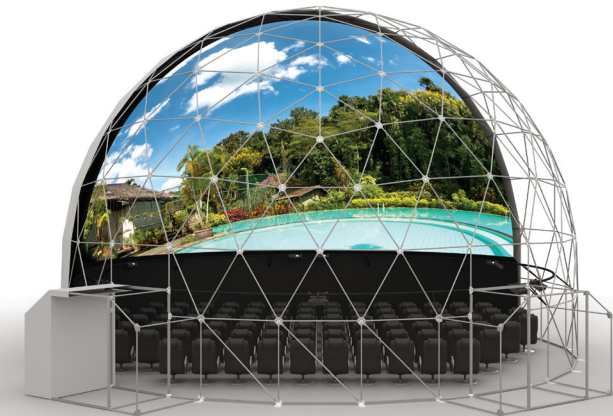
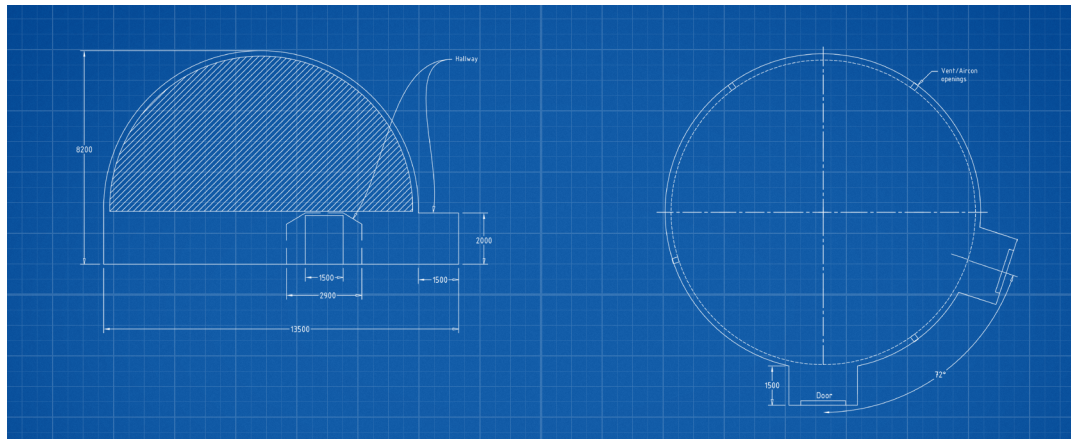
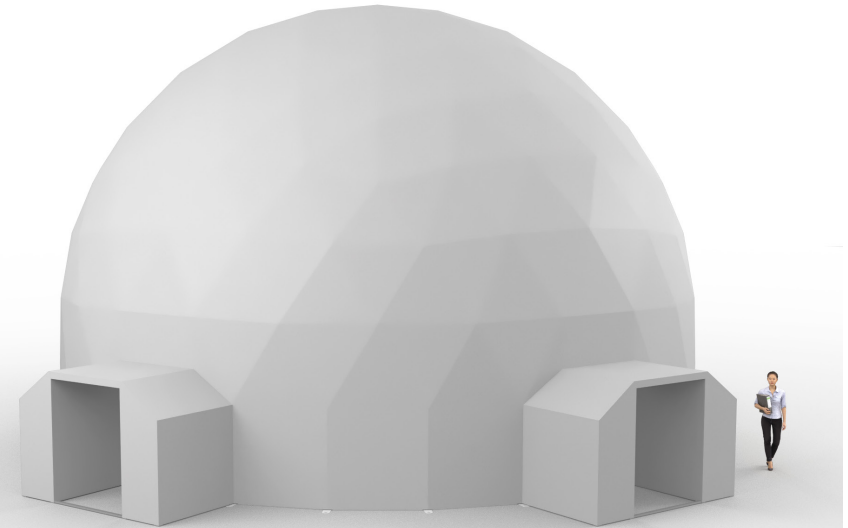

Standard AV (upgradable)		Space		Dimensions		Environment		Installation	
# Projectors	8	Floor Area	110 m <sup>2</sup>	Diameter	12 m	Indoor/Outdoor	Indoor / Restricted outdoor	Shipping Weight	1.180 kg
Active Resolution (Arc)	4.5K	Screen Area	210 m <sup>2</sup>	Height	8.2 m	Frame	25mm steel, 50mm Al6061	Dome Setup Time	6-14 hours
Active Pixels	13271000	Standing Capacity	120	Width	12 m	Truss	50 mm Al6061 T6	Dismantle Time	4-6 hours
Visible Lumens	24280	Standard Chair Capacity	94	Door Width	1.5 m	Wind Load	Occasional 35 m/s gusts	Total Ballast Weight	1000 kg
Contrast	10.000:1	Theater Seat Capacity	81	Door Height	2 m	Snow Load	250 kg per sq meter	# Ballast Points	25
Display Technology	DLP	Luxury Seat Capacity	29	Vent Openings	5X 300 mm	Fire Rating	Synthetic self-extinguishing	Electrical (standard)	3.2 kW avg, 4.3 kW max
Audio	5.1 Surround	Number of Doors	2						

## 14M Immersive Event Dome

Deliver immersive and unforgettable 360° experiences to audiences anywhere. Our Immersive Event Domes have overhead projection and can be used for standing or seated experiences in numerous configurations. Their reinforced structures are suitable for outdoor use.

The 14M Immersive Event is ideal for:

- Creating digital and dynamic environments
- Events and exhibitions
- Education and simulation
- Bringing 360 VR content to large audiences (approx 110X the viewer throughput of a VR head mounted display)
- Music, art, and dance
- Live and interactive presentations and performances

Includes a complete system: dome, Omnispace server, iPad with user interface, projection system, and 5.1 surround sound.

Numerous upgrades, accessories, software modules, and content options are available.

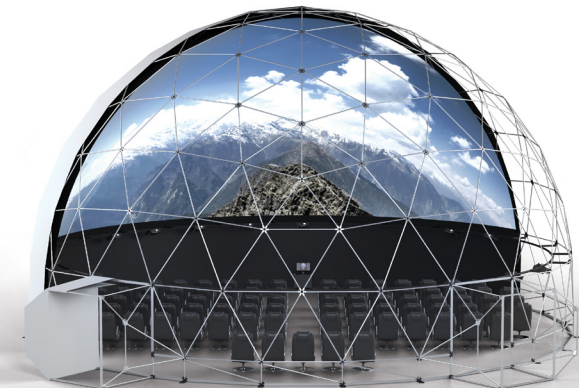
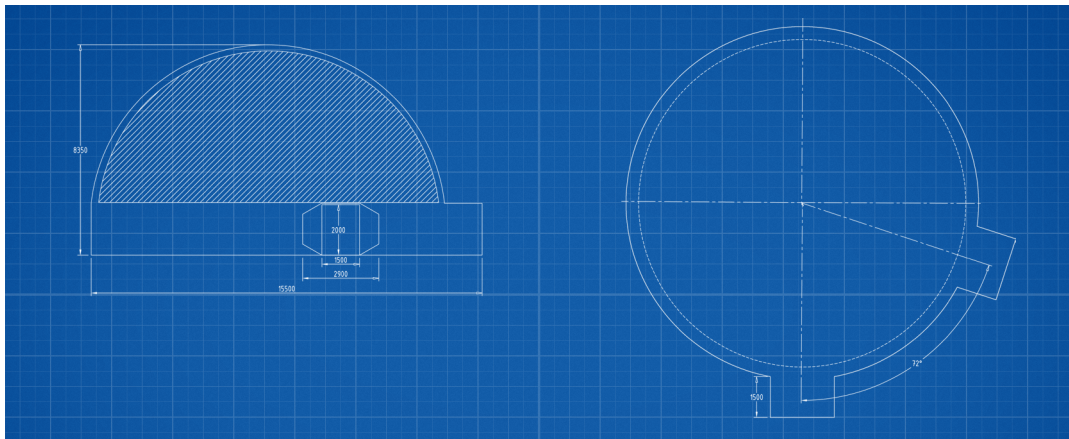
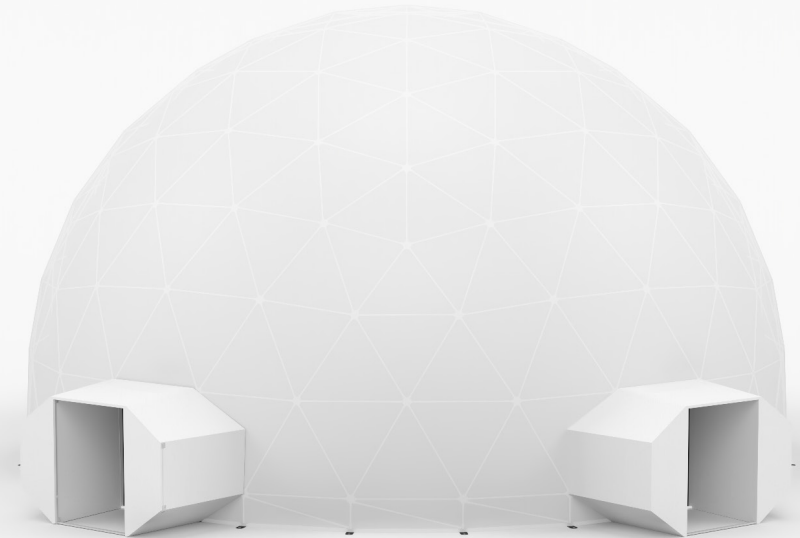

Standard AV (upgradable)		Space		Dimensions		Environment		Installation	
# Projectors	8	Floor Area	135 m <sup>2</sup>	Diameter	14 m	Indoor/Outdoor	Indoor and outdoor rated	Shipping Weight	2.150 kg
Active Resolution (Arc)	4.5K	Screen Area	270 m <sup>2</sup>	Height	9.4 m	Frame	32mm steel struts	Dome Setup Time	Site determined
Active Pixels	13271000	Standing Capacity	130	Width	14 m	Truss	50 mm AL Round Pipe	Dismantle Time	Site determined
Visible Lumens	33200	Standard Chair Capacity	Configurable	Door Width	1.3 m	Wind Load	38 m/s (Beaufort 12)	Total Ballast Weight	Site determined
Contrast	10.000:1	Theater Seat Capacity	Configurable	Door Height	2.1 m	Snow Load	260 kg m <sup>2</sup> 100	# Ballast Points	Site determined
Display Technology	DLP	Luxury Seat Capacity	Configurable	Vent Openings	5X. 51cm dia.	Fire Rating	Flame retar. poly. and pvc	Electrical (standard)	6.5 kW avg. 8.6 kW max
Audio	5.1 Surround	Number of Doors	2						



## 21M Virtual Environment Dome

Deliver immersive and unforgettable 360° experiences to audiences anywhere. Our Virtual Environment Domes have overhead projection and can be used for standing or seated experiences in numerous configurations. Their reinforced structures are suitable for outdoor use.

The 21M-VED is ideal for:

- Creating digital and dynamic environments
- Events and exhibitions
- Education and simulation- Bringing 360 VR content to large audiences
- Music, art, and dance
- Live and interactive presentations and performances

Includes a complete system: dome, Omnispace server, iPad with user interface, projection system, and 5.1 surround sound.

Numerous upgrades, accessories, software modules, and content options are available.

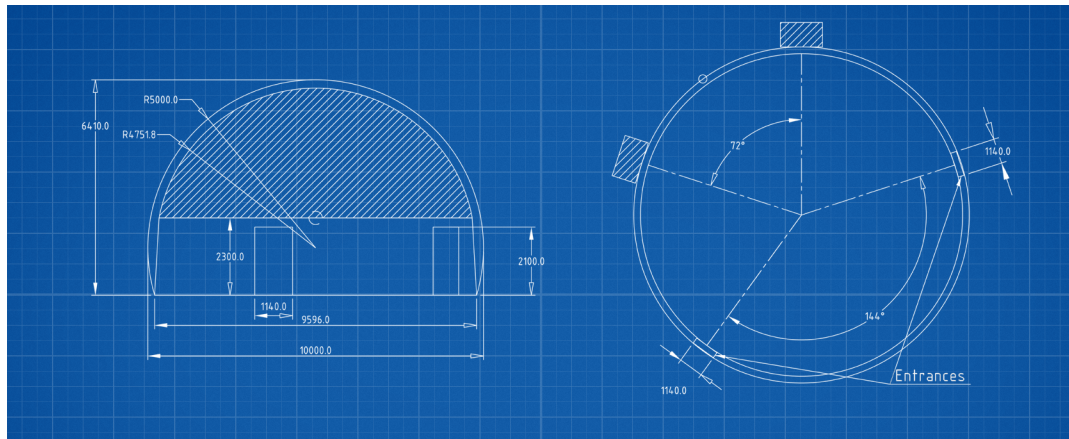

Standard AV (upgradable)		Space		Dimensions		Environment		Installation	
# Projectors	8+	Floor Area	333 m <sup>2</sup>	Diameter	21 m	Indoor/Outdoor	Outdoor	Shipping Weight	4.150 kg
Active Resolution (Arc)	4.7K+	Screen Area	750 m <sup>2</sup>	Height	13.5 m	Frame	40 mm Steel	Dome Setup Time	Site determined
Active Pixels	14,008,320+	Standing Capacity	300	Width	21 m	Truss	50 mm AL6061 T6	Dismantle Time	Site determined
Visible Lumens	124,800+	Standard Chair Capacity	255	Door Width	2 m	Wind Load	35 m/s. Beaufort 11	Total Ballast Weight	6500 kg
Contrast	10,000:1	Theater Seat Capacity	200	Door Height	2.1 m	Snow Load	300 kg m <sup>2</sup> 100	# Ballast Points	28
Display Technology	DLP	Luxury Seat Capacity	150	Vent Openings	5X 510 mm	Fire Rating	Synthetic self-extinguishing	Electrical (standard)	10 kW avg, 16 kW max
Audio	5.1 Surround	Number of Doors	2						

## 27M Virtual Environment Dome

Deliver immersive and unforgettable 360° experiences to audiences anywhere. Our Virtual Environment Domes have overhead projection and can be used for standing or seated experiences in numerous configurations. Their reinforced structures are suitable for outdoor use.

The 27M-VED is ideal for:

- Creating digital and dynamic environments
- Events and exhibitions
- Education and simulation- Bringing 360 VR content to large audiences
- Music, art, and dance
- Live and interactive presentations and performances

Includes a complete system: dome, Omnispace server, iPad with user interface, projection system, and 5.1 surround sound.

Numerous upgrades, accessories, software modules, and content options are available.

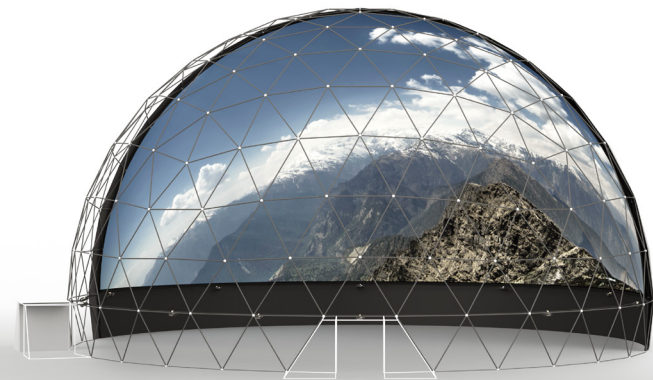
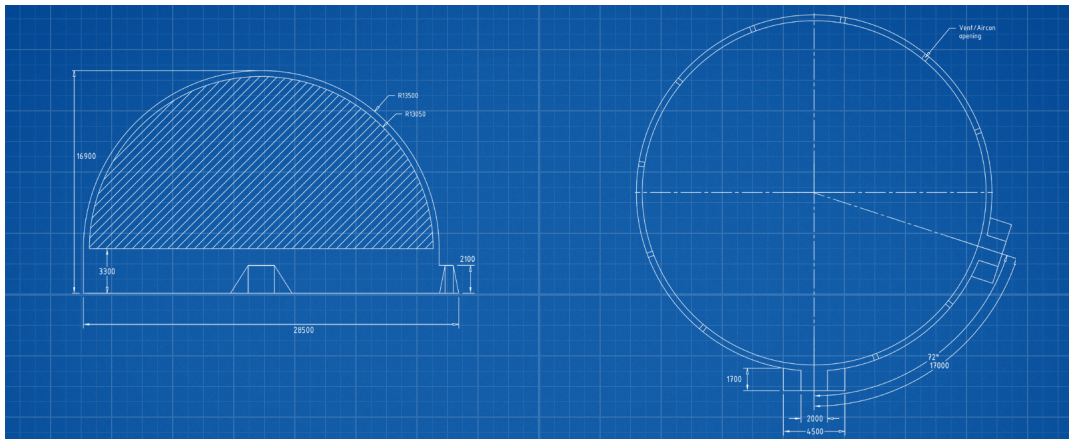
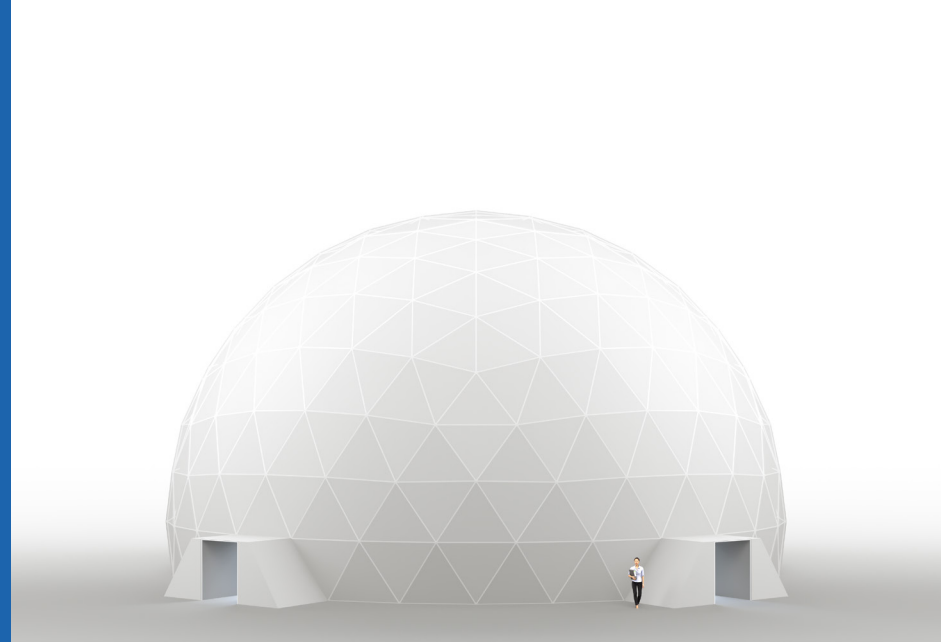

Standard AV (upgradable)		Space		Dimensions		Environment		Installation	
# Projectors	8+	Floor Area	537m <sup>2</sup>	Diameter	27 m	Indoor/Outdoor	Outdoor	Shipping Weight	9600 kg
Active Resolution (Arc)	4.7K+	Screen Area	1070 m <sup>2</sup>	Height	16.1 m	Frame	50 mm Steel	Dome Setup Time	Site determined
Active Pixels	14,008,320+	Standing Capacity	540	Width	27 m	Truss	50 mm AL6061 T6	Dismantle Time	Site determined
Visible Lumens	124,800+	Standard Chair Capacity	420	Door Width	2 m	Wind Load	35 m/s. Beaufort 11	Total Ballast Weight	15500 kg
Contrast	10,000:1	Theater Seat Capacity	380	Door Height	2.1 m	Snow Load	440 kg m <sup>2</sup> 100	# Ballast Points	28
Display Technology	3DLP	Luxury Seat Capacity	340	Vent Openings	5X 510 mm	Fire Rating	Synthetic self-extinguishing	Electrical (standard)	22kW avg, 36kW max
Audio	5.1 Surround	Number of Doors	2						



## 35M Virtual Environment Dome

Deliver immersive and unforgettable 360° experiences to audiences anywhere.

Our Virtual Environment Domes have overhead projection and can be used for standing or seated experiences in numerous configurations. Their reinforced structures are suitable for outdoor use.

The 35M-VED is ideal for:

- Creating digital and dynamic environments
- Events and exhibitions
- Education and simulation- Bringing 360 VR content to large audiences
- Music, art, and dance
- Live and interactive presentations and performances

Includes a complete system: dome, Omnispace server, iPad with user interface, projection system, and 5.1 surround sound.

Numerous upgrades, accessories, software modules, and content options are available.

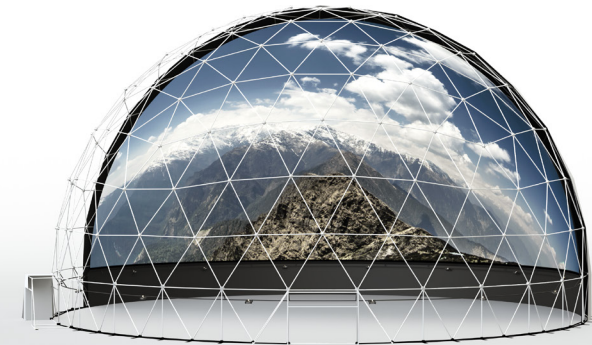
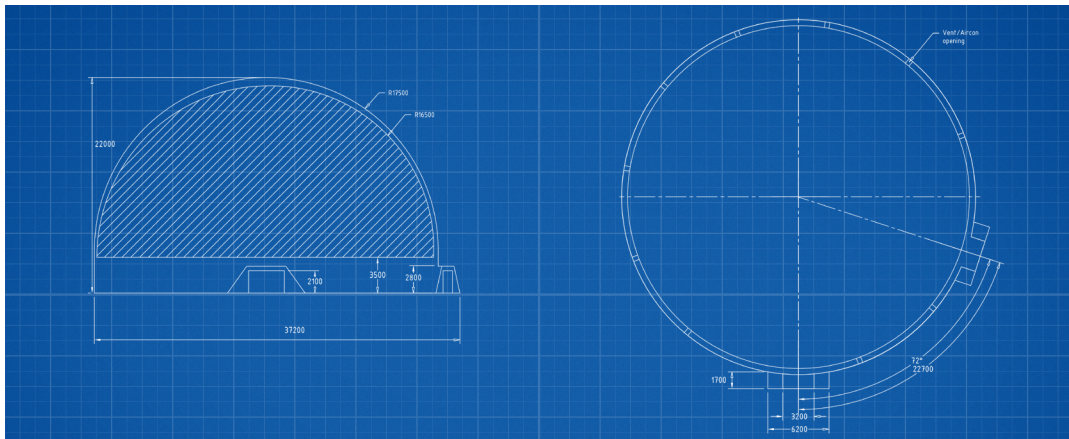

Standard AV (upgradable)		Space		Dimensions		Environment		Installation	
# Projectors	16+	Floor Area	925 m <sup>2</sup>	Diameter	35 m	Indoor/Outdoor	Outdoor	Shipping Weight	28.000 kg
Active Resolution (Arc)	6.5K+	Screen Area	1.930 m <sup>2</sup>	Height	18 m	Frame	50mm and 90mm steel	Dome Setup Time	Site determined
Active Pixels	27.5 million+	Standing Capacity	750	Width	35 m	Truss	50 steel	Dismantle Time	Site determined
Visible Lumens	236.800+	Standard Chair Capacity	Configurable	Door Width	2 m	Wind Load	38 m/s (Beaufort 12)	Total Ballast Weight	Site determined
Contrast	10.000:1	Theater Seat Capacity	Configurable	Door Height	2.1 m	Snow Load	100 kg m <sup>2</sup> 100	# Ballast Points	Site determined
Display Technology	3DLP	Luxury Seat Capacity	Configurable	Vent Openings	10X. 510 mm.	Fire Rating	Flame retardant poly. & pvc	Electrical (standard)	36kW avg, 48kW max
Audio	5.1+	Number of Doors	2 to 5						